



LAVIANO



Progetto per la ristrutturazione e l'adeguamento funzionale del Mulino ubicato in località Vallone da destinare a info point e museo dell'acqua

Tav. 10

Stato di Progetto

Particolari Costruttivi

Ufficio Tecnico

Progetto Esecutivo

Luglio 2017

STATO DI FATTO

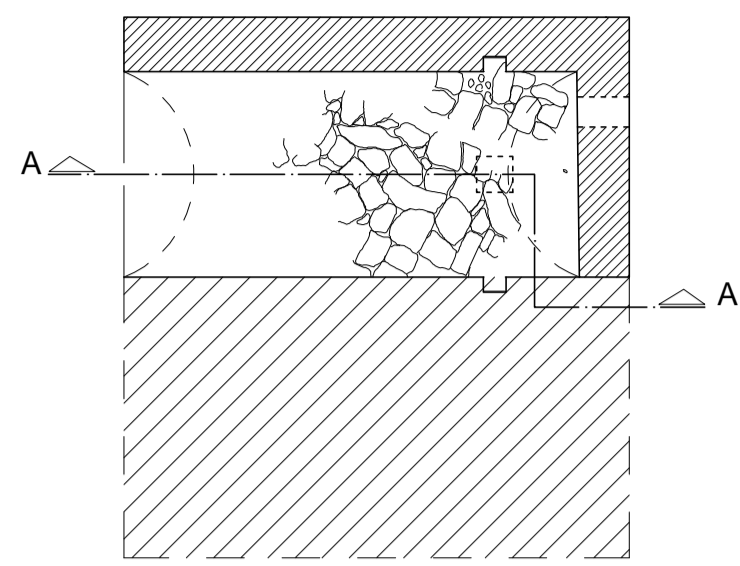

Pianta Livello Seminterrato

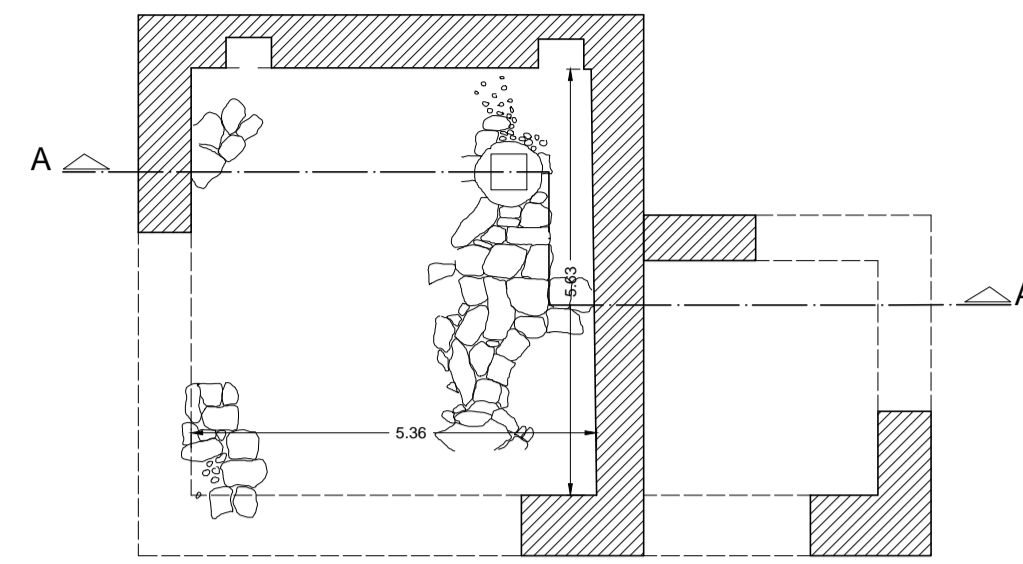

Pianta Livello Pavimento

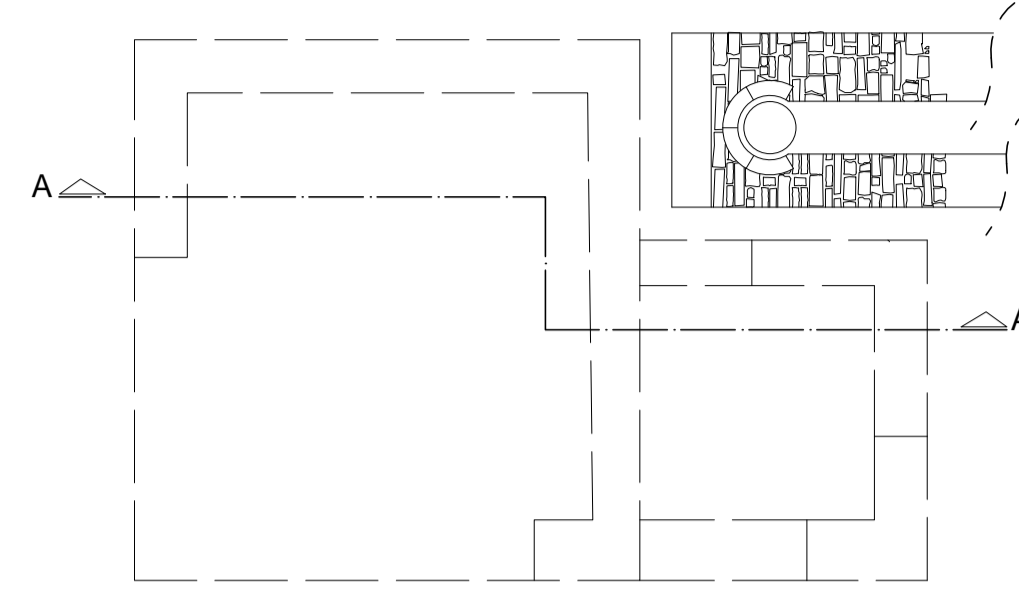

Pianta Copertura

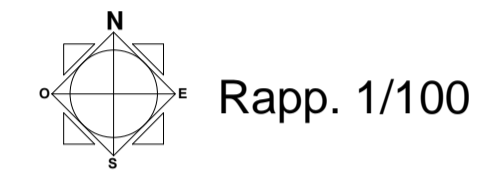

Tecnica di posa in opera delle pietre

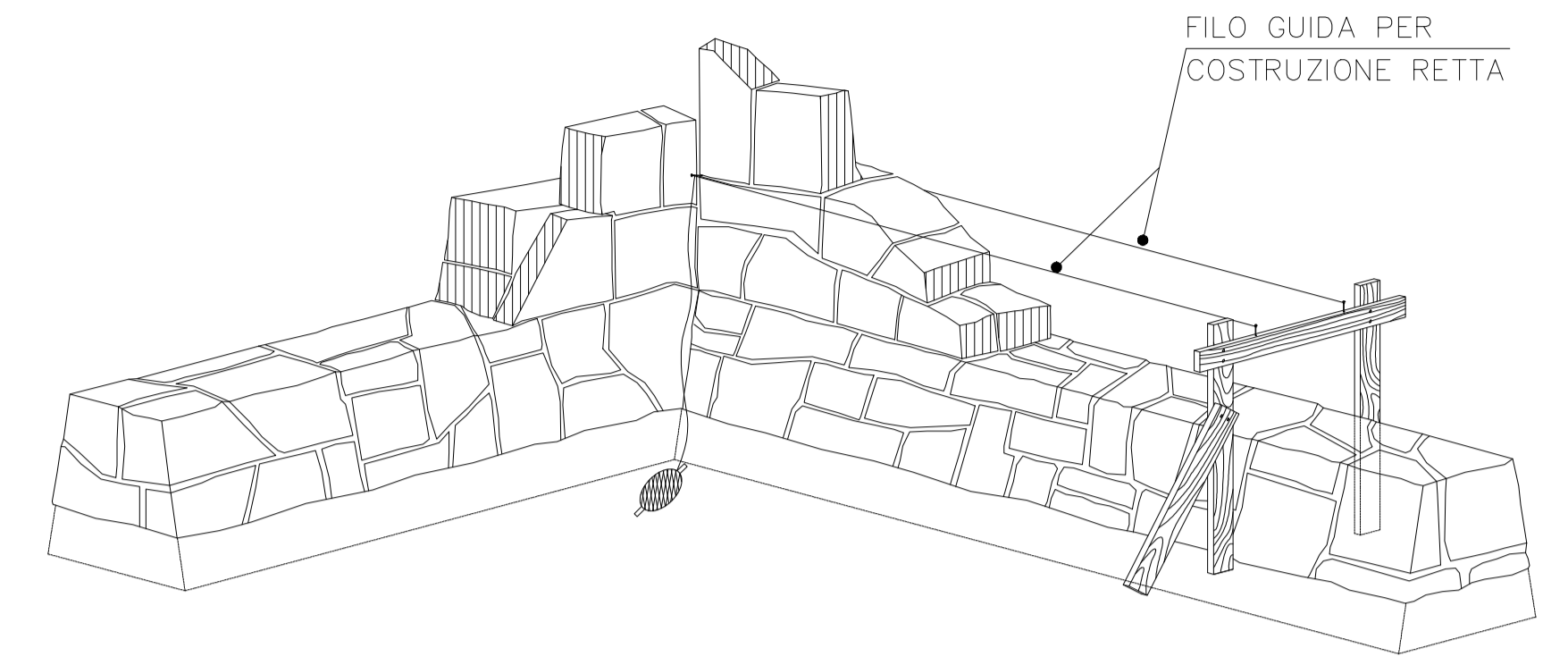

Ripristino delle zone danneggiate o degradate

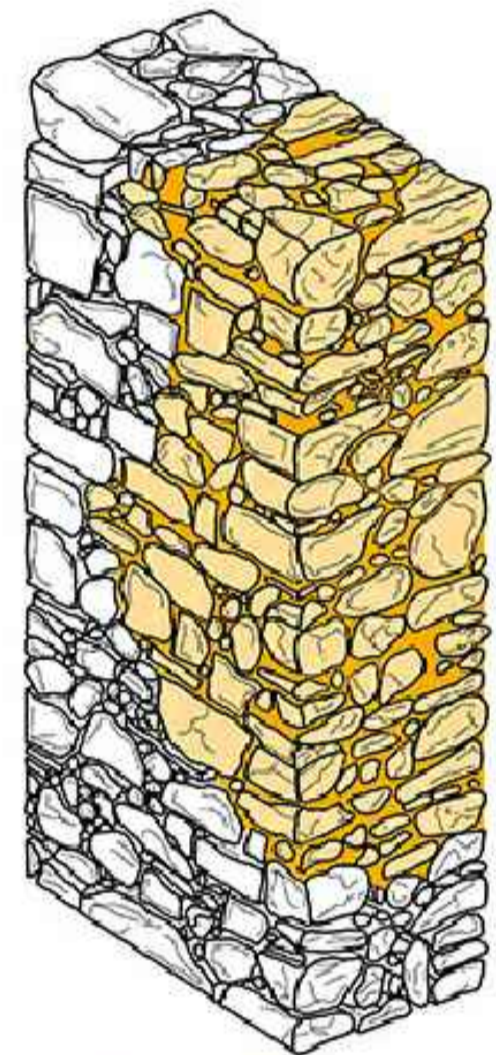

Scuci e cuci

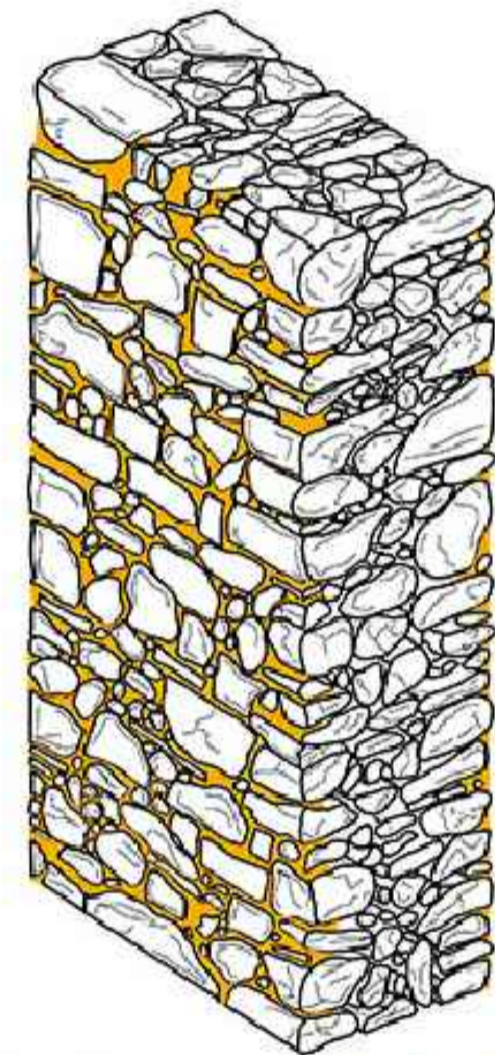

Ristilatura dei giunti

Particolare abaco porta

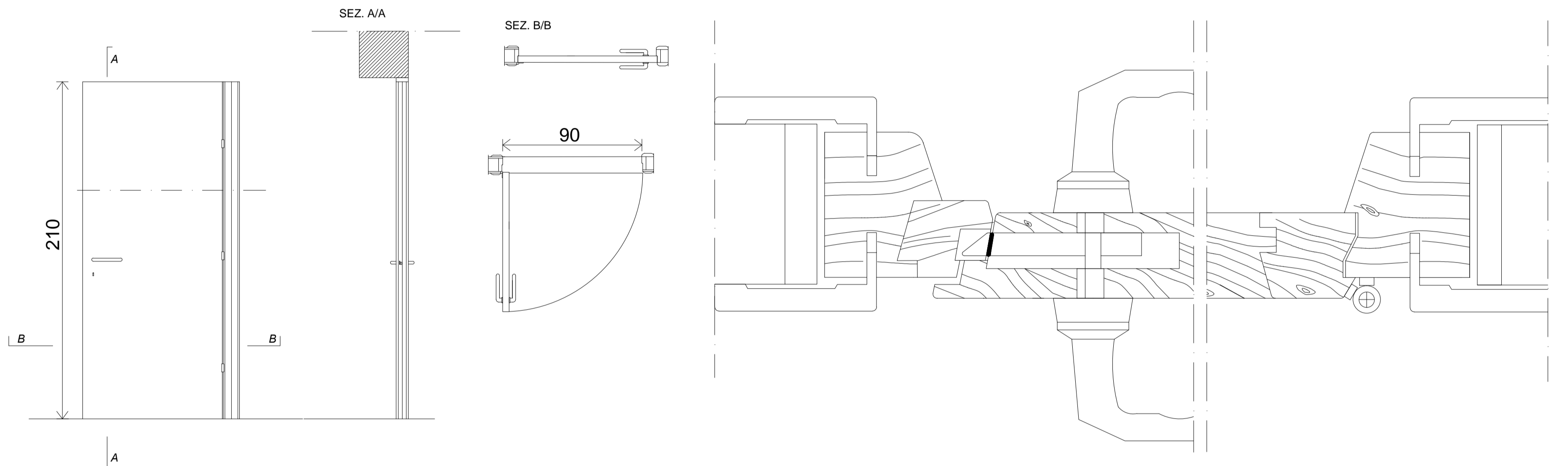

Particolare tetto di copertura

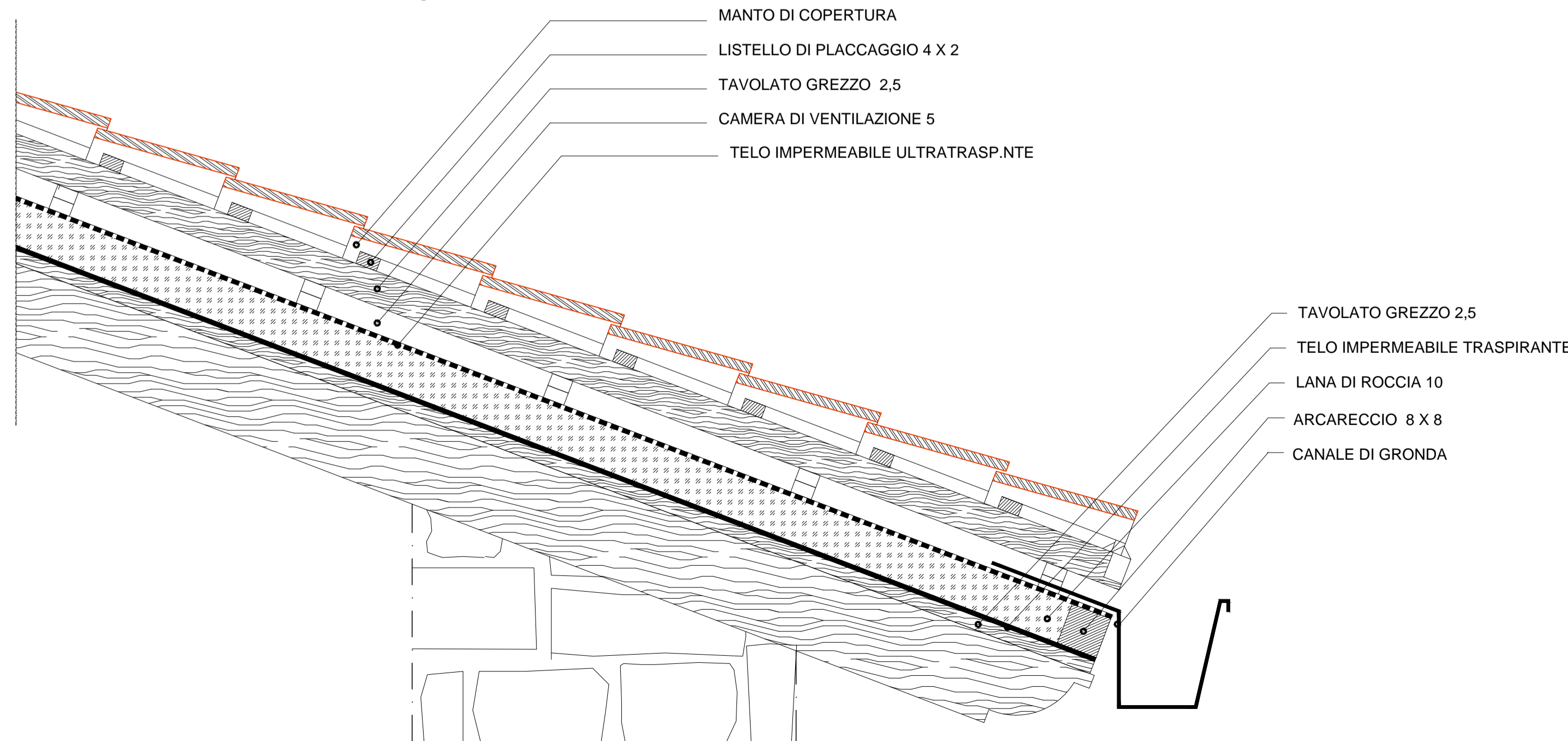

Sez. B-B'

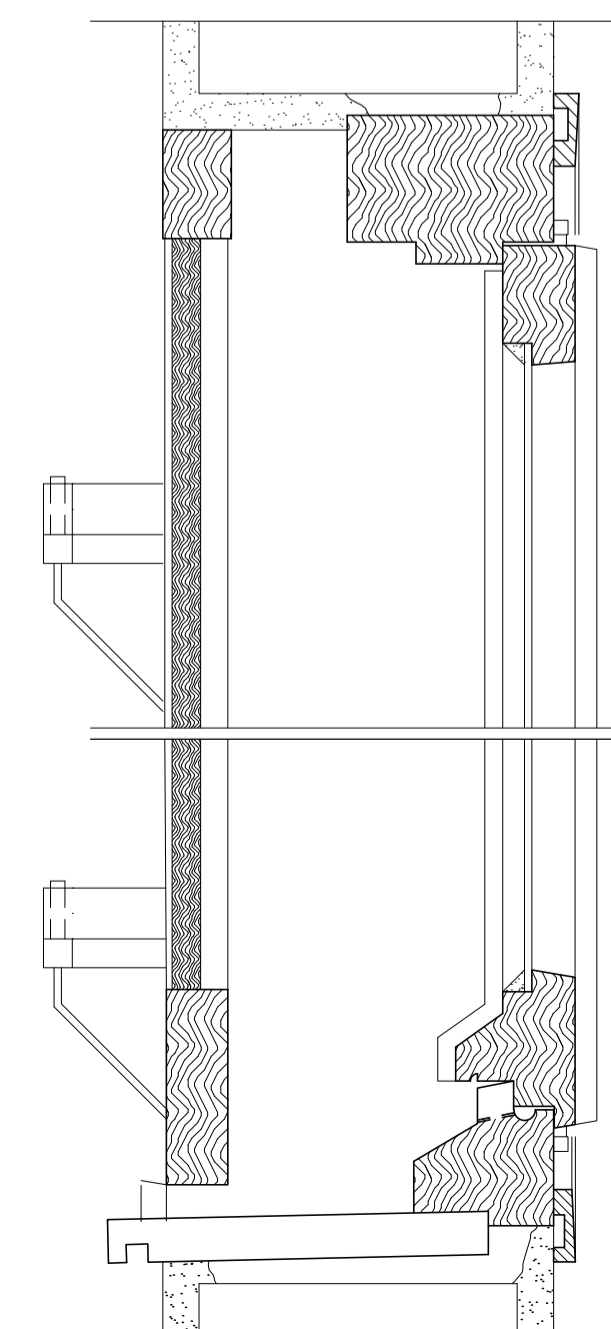

Particolare abaco infisso

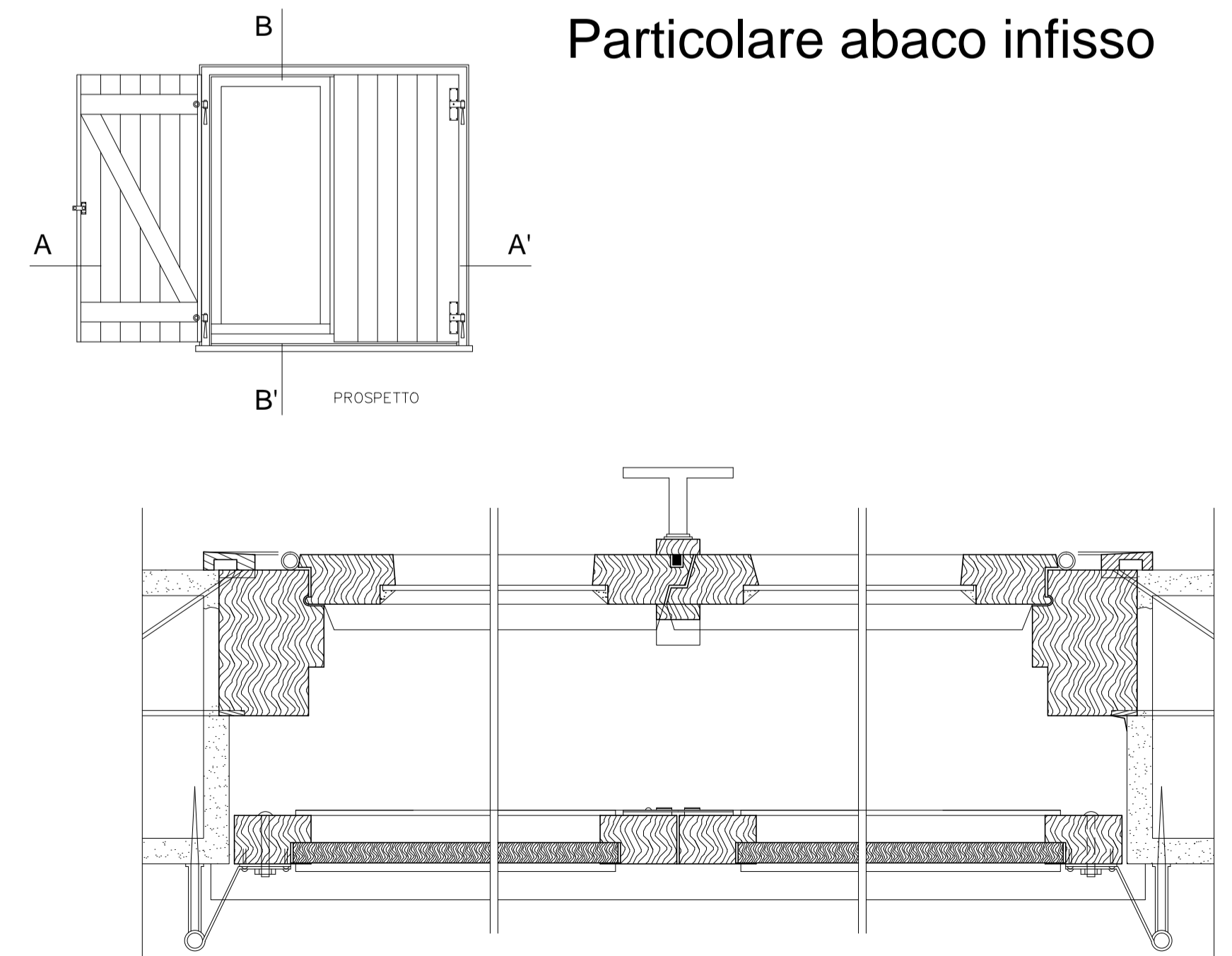

FINESTRA A DUE ANTE CON SCURI ESTERNI

Sez. A-A'